



Abmessung Dimension Medidas Ø D x B x d mm	Z	Best.-Nr. Order-No. Réf.-No. Ref.no.	EUR*
110 x 40 x 30	2	1 003 940	79,80
135 x 40 x 30	2	1 253 940	126,80
135 x 40 x 40	2	1 253 941	120,80
160 x 40 x 30	2	1 503 940	136,60
125 x 50/40 x 30 - Stahl	2 (50 mm + 40 mm möglich)	1 253 951	132,50



Holzkasten / Wooden Box / Coffret bois / Caja de madera

für Profilmesser und Messerköpfe Ø 110 mm / for profile knives and cutter blocks Ø 110 mm
pour fers profilés et porte-outil Ø 110 mm / para portacuchillas y cuchillas perfiladas Ø 110 mm

Type	Anzahl/Messer Qty. of knives Nombre de fers Piezas de cuchillas	Anzahl/Sets Qty. of sets Nombre de sets Piezas de set	Best.-Nr. Order-No. Réf.-No. Ref. No.	EUR*
UMK 30	24	6	1 303 100	15,10
UMK 31	48	12	1 303 101	20,80
UMK 32	72	18	1 303 102	27,20
UMK 33	96	24	1 303 103	30,10

Holzkasten / Wooden Box / Coffret bois / Caja de madera

für Profilmesser und Messerköpfe Ø 135 mm / for profile knives and cutter blocks Ø 135 mm
pour fers profilés et porte-outil Ø 135 mm / para portacuchillas y cuchillas perfiladas Ø 135 mm

UMK 35	24	6	1 303 105	18,00
UMK 36	48	12	1 303 106	23,80

Universal-Sicherheitsfräskopf 110x40x30 mm in Holzbox

Universal-Cutter blocks 110x40x30 mm in wooden box

Porte-outils 110x40x30 mm dans coffret bois

Fresas universales 110x40x30 mm in caja de madera



Holzkasten mit Fräskopf und Profilmesser

Wooden box with cutter block and profile-knives
Coffret bois avec outils et fers profilés
Caja de madera con fresas y portacuchillas

Type	Anzahl/Paar/pair/ Profilmesser Profile knives Fers profiles Cuchillas perfil	Anzahl/Paar Abweiser Deflector Déflecteur Limitador	Best.-Nr. Order-No. Réf. No Ref.no.	EUR*
UMK 03	6	6	100 394 012	215,90
UMK 04	12	12	100 394 024	352,10
UMK 53	18	18	100 394 036	488,20
UMK 54	24	24	100 394 048	624,30

Profilmesser und Abweiserplatten für Universalmesserköpfe

Profile-knives and chip limiters for universal-cutter blocks

Fers profiles et contrefers pour porte outils

Cuchillas perfiladas y desviadoras para fresas universales

			Best.-Nr. Order-No. Réf.-No. Ref.no.	EUR*
Profilmesser in HLS-Stahl mit seitlichem Freiwinkel				
Profile-knives	HLS steel	Nr. 1 - 36	403 901 - 936	6,30
Fers profilés	acier HLS	Nr. 37 - 95	403 937 - 995	7,50
Cuchillas perfiladas en acero HLS con ángulo libre lateral				
Abweiserplatten	profiliert			
Chiplimiters	profiled	Nr. 1 - 36	403 801 - 836	5,15
Contrefers	profilés			
Desviadores	perfilados	Nr. 37 - 95	403 837 - 895	5,15
Profilmesser-Set	2 Profilmesser + 2 Abweiser)			
Profile knife set	2 + 2			
Fers profilés set	2 + 2	Nr. 1 - 36	403 701 - 736	22,90
Set de cuchillas perfiladas	2 + 2	Nr. 37 - 95	403 737 - 795	25,30
Falzmesser / rebate knife			403 900	4,70
Blanketts / Blanks			403 999	4,60
Konterprofil-Messer / Counter profile-knife		Nr. 1 - 4	403 501 - 504	9,30
Konterprofil-Abweiser / Counter profile deflector		Nr. 1 - 4	403 401 - 404	5,30
Abplattmesser / panel raising knife			403 510	7,60
Abweiser/ Chip limiters / Contrefers / Desviadores			403 410	5,30

...Abbildung siehe Seite / Illustrations on page /
Illustrations sur la page / Ilustraciones en la página 20-29

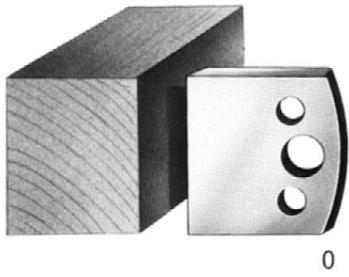

0

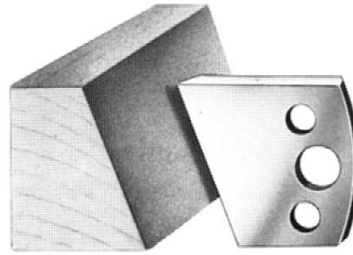
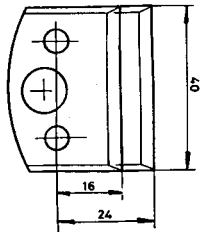

1

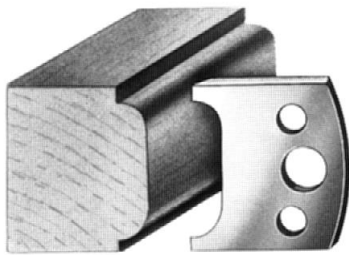
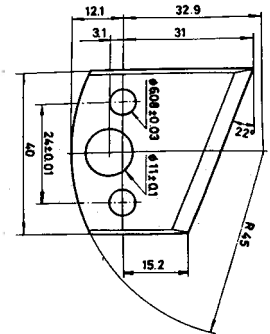

2

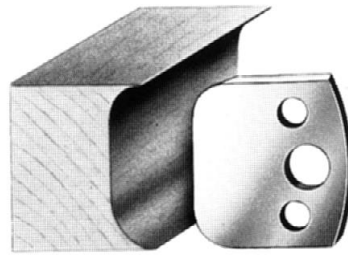
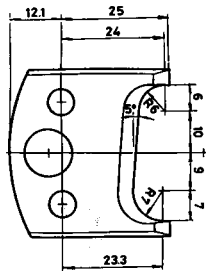

3

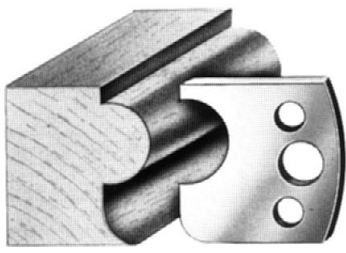
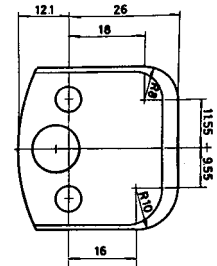

4

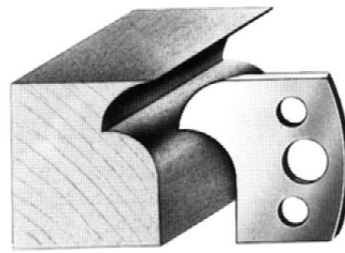
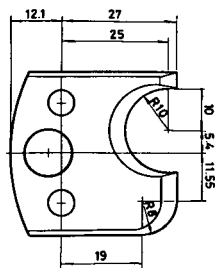

5

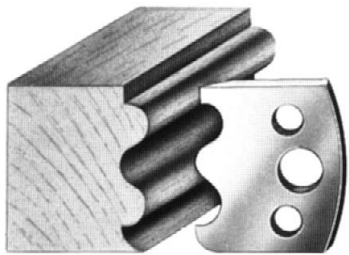
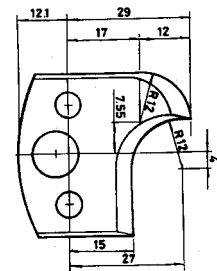

6

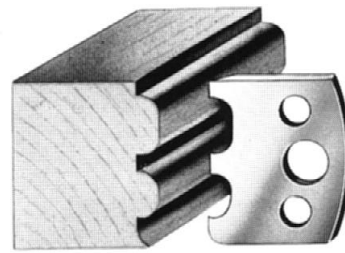
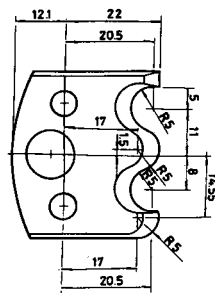

7

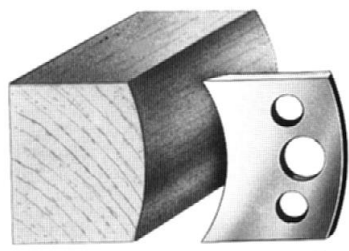
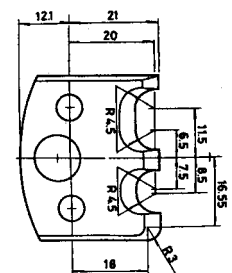

8

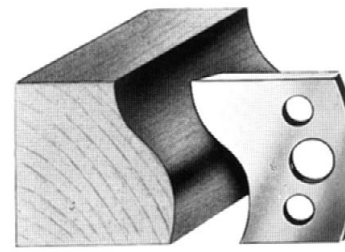
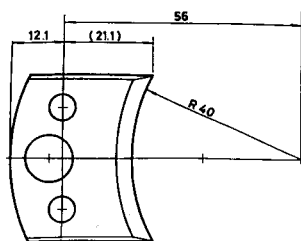

9

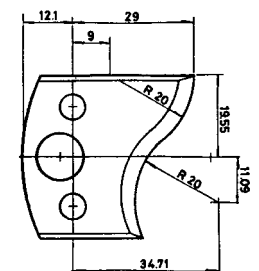

Profilmesser in HLS-Stahl und Abweiserplatten passend für Universal-Messerköpfe

Profile-knives in HLS-steel and chip limiters for universal cutter blocks
Fers profilés en acier HLS et contrefers pour porte-outils universels
Cuchilla perfilada en acero HLS y placas desviadoras para portacuchillas universales

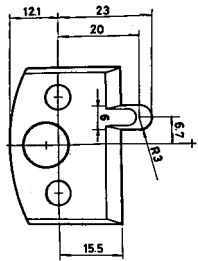
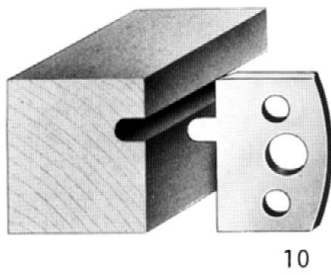

10

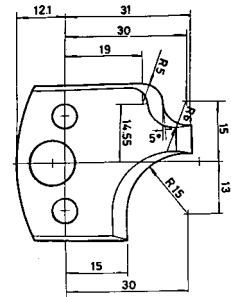
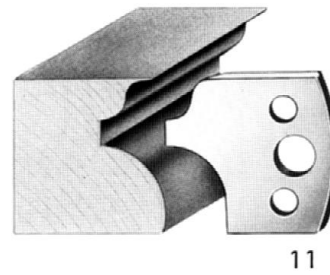

11

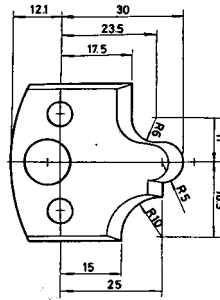
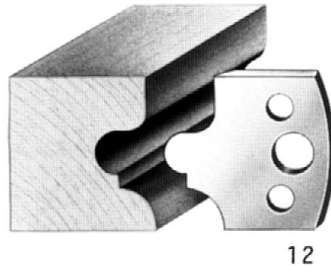

12

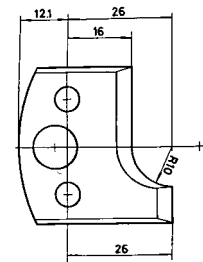
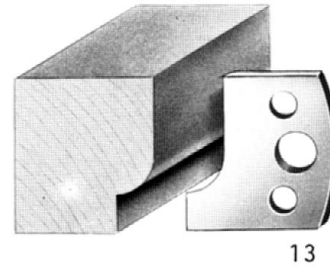

13

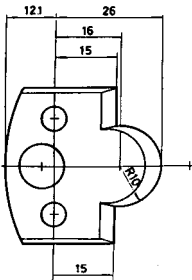
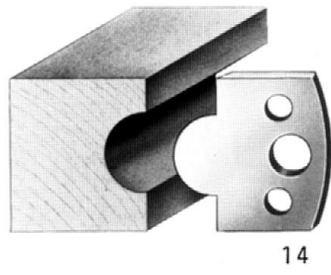

14

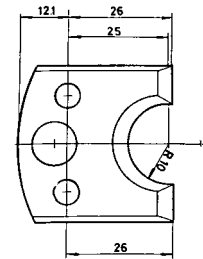
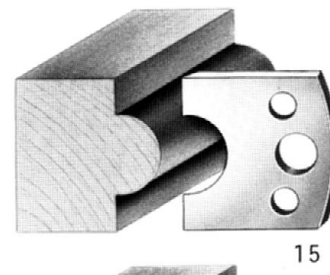

15

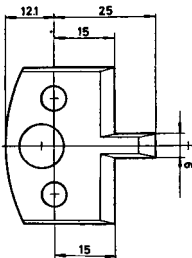
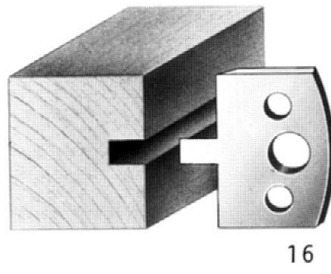

16

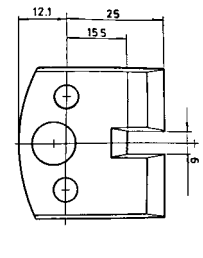
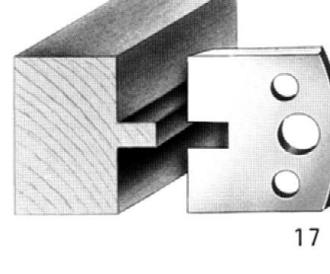

17

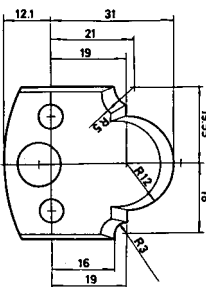
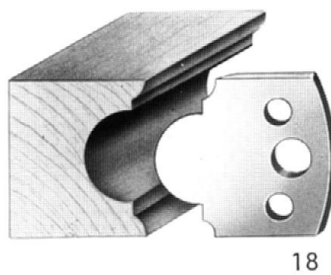

18

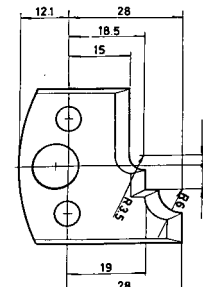
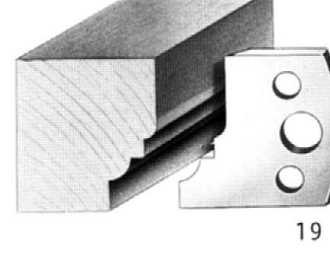

19

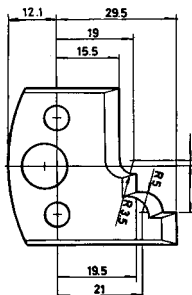
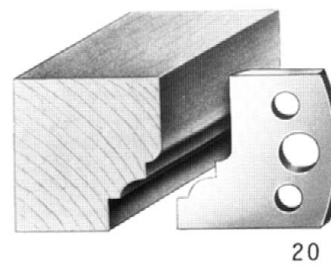

20

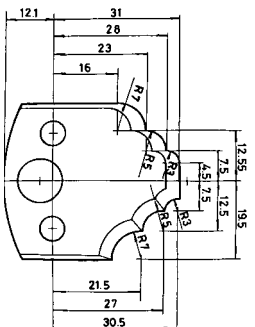
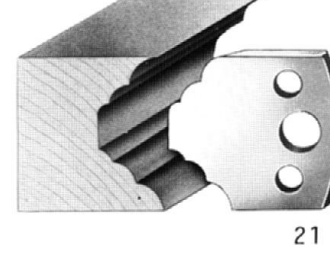

21

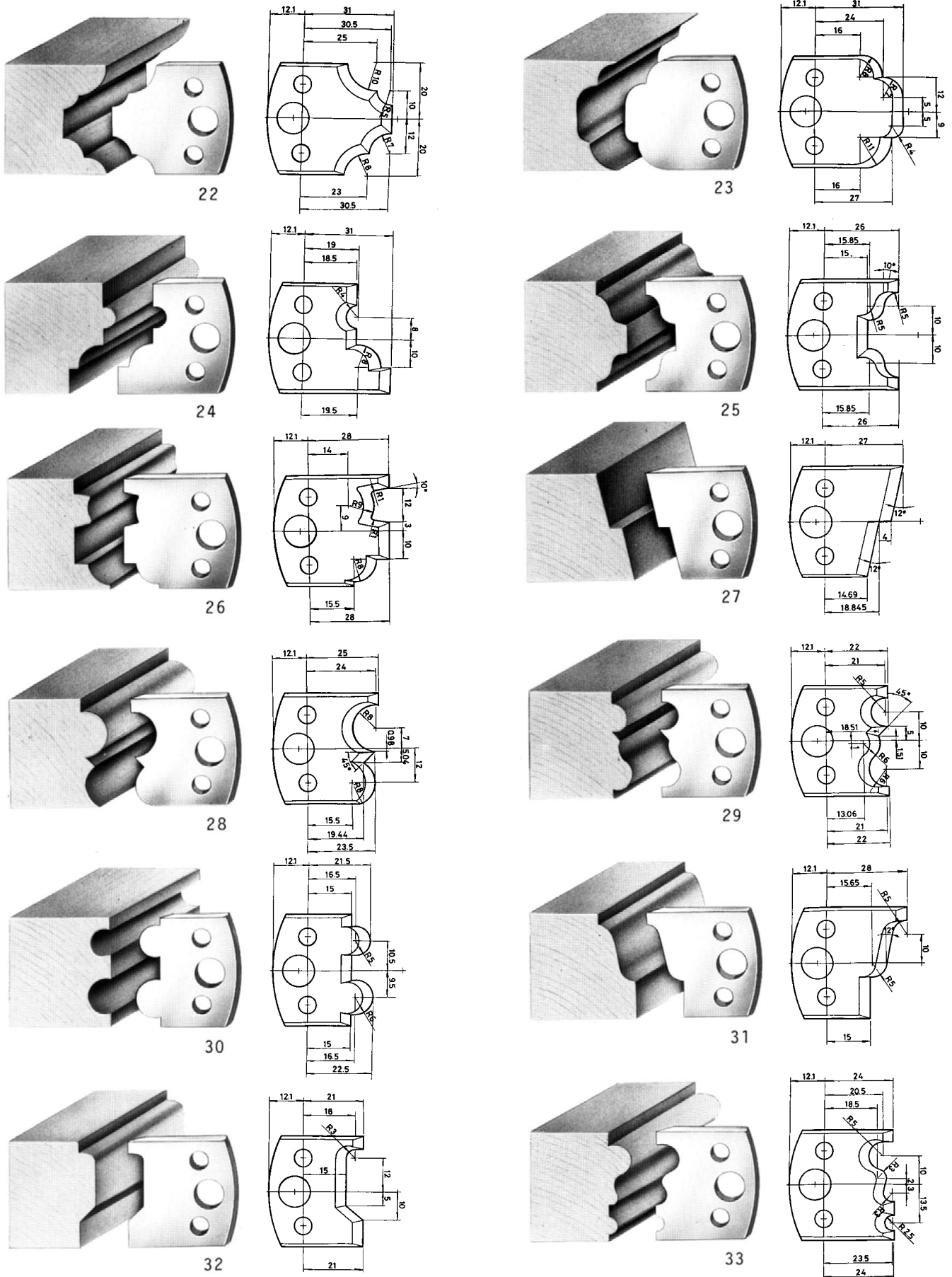

Profilmesser in HLS-Stahl und Abweiserplatten passend für Universal-Messerköpfe

Profile-knives in HLS-steel and chip limiters for universal cutter blocks
Fers profilés en acier HLS et contrefers pour porte-outils universels
Cuchilla perfilada en acero HLS y placas desviadoras para portacuchillas universales

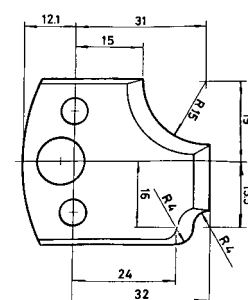
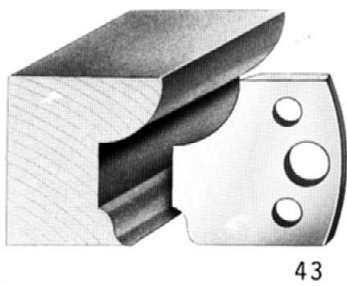
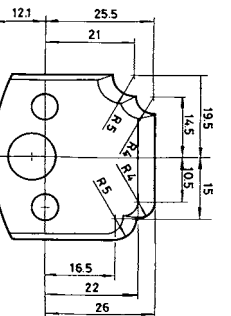
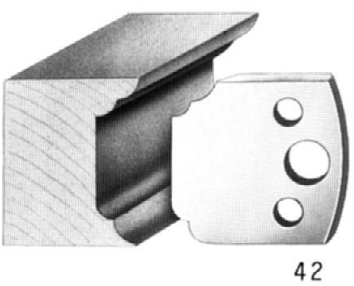
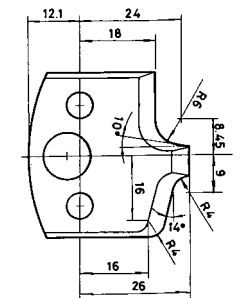
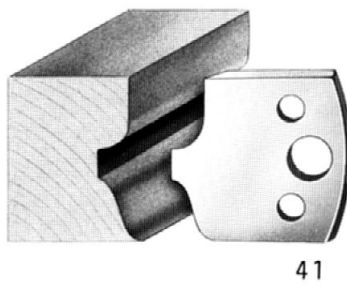
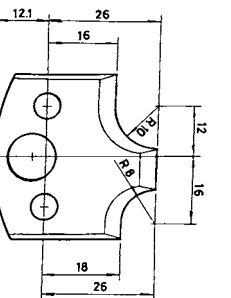
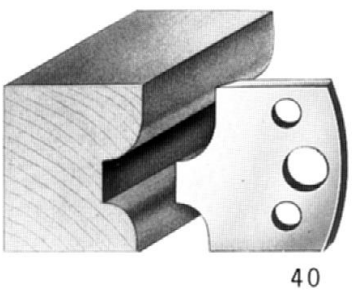
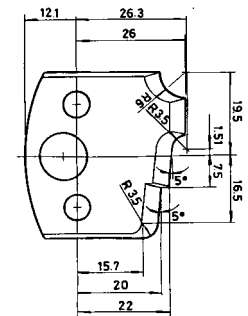
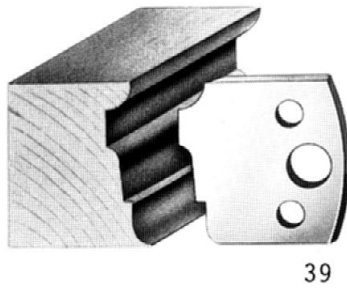
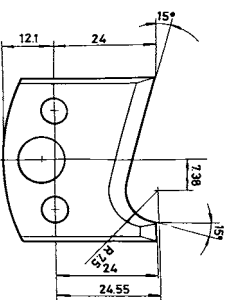
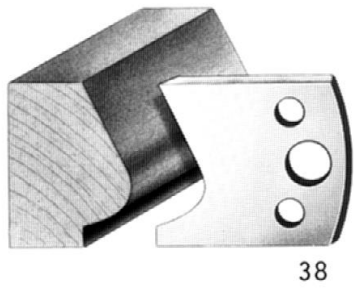
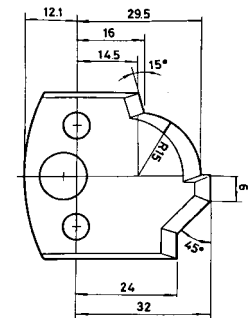
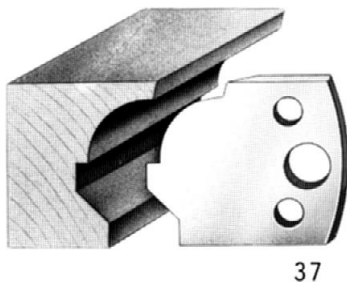
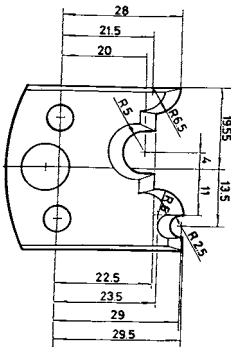
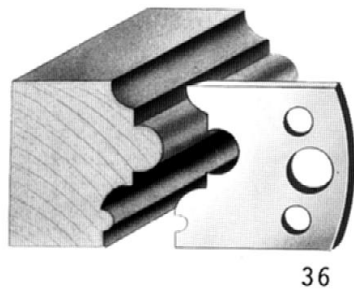
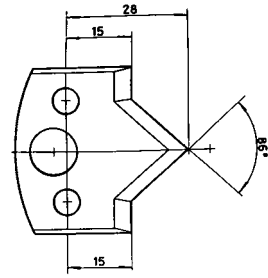
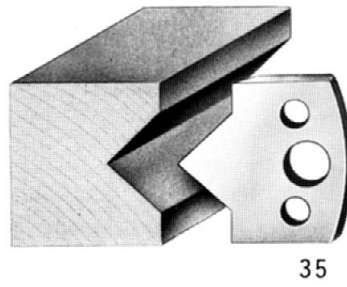
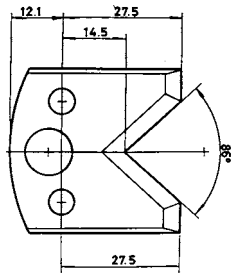
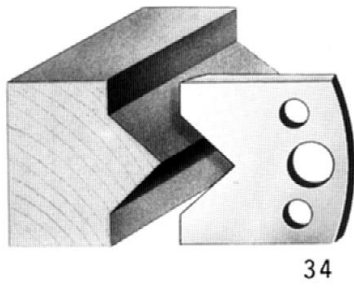

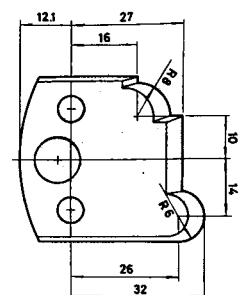
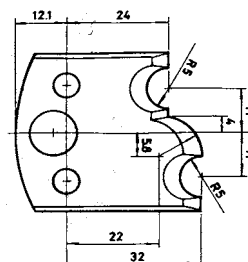
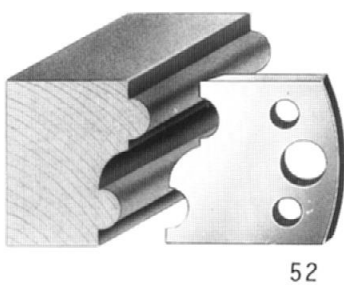
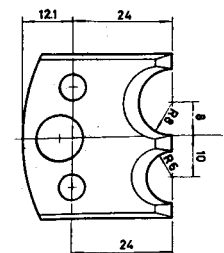
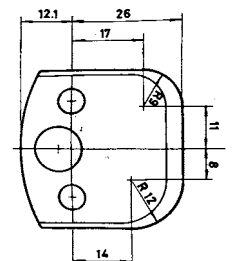
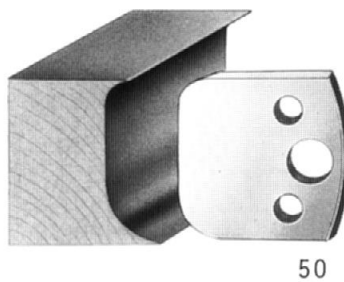
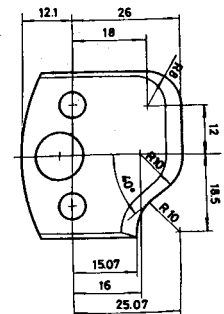
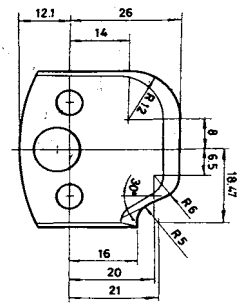
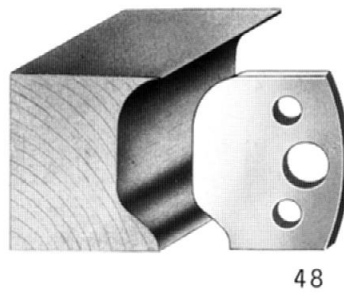
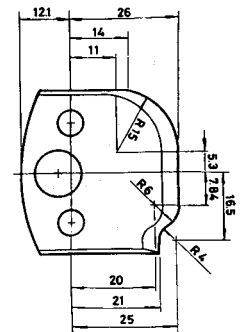
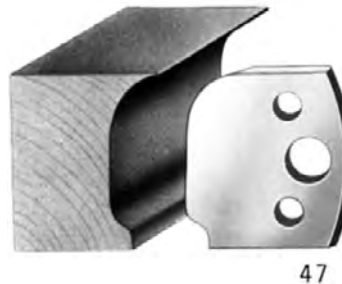
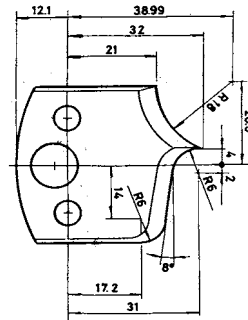
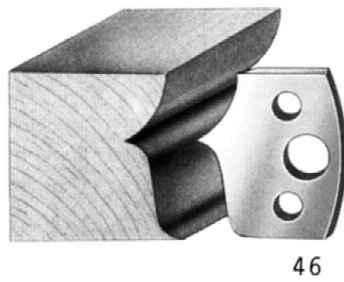
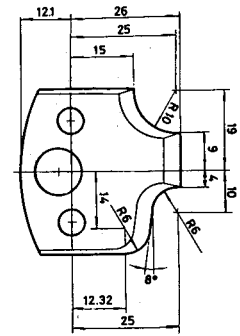
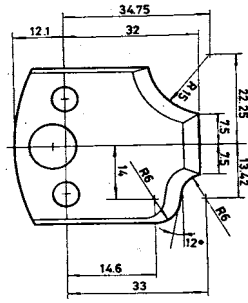
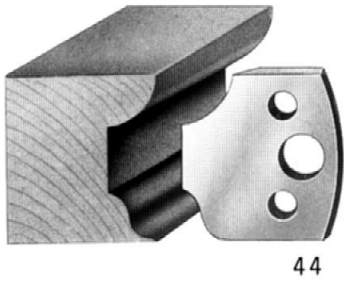

Profilmesser in HLS-Stahl und Abweiserplatten passend für Universal-Messerköpfe

Profile-knives in HLS-steel and chip limiters for universal cutter blocks
Fers profilés en acier HLS et contrefers pour porte-outils universels
Cuchilla perfilada en acero HLS y placas desviadoras para portacuchillas universales

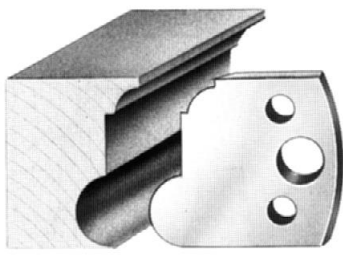

54

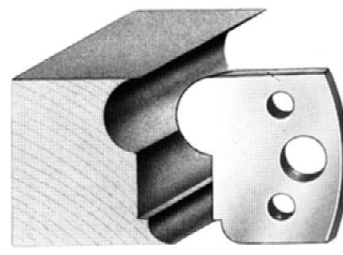
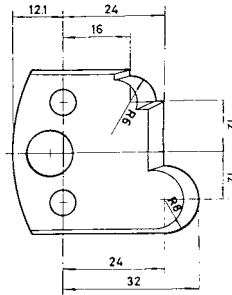

55

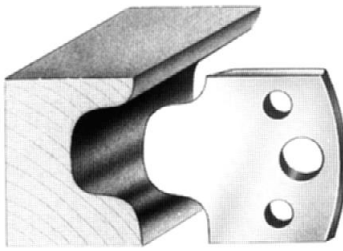
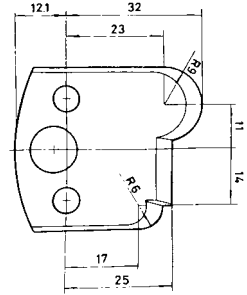

56

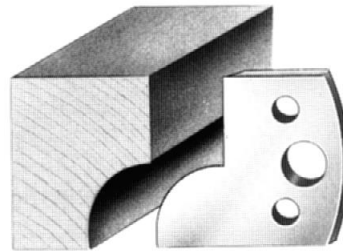
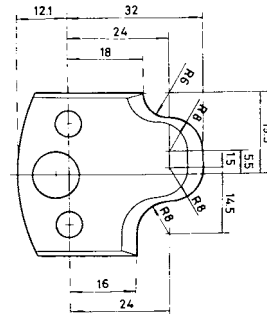

57

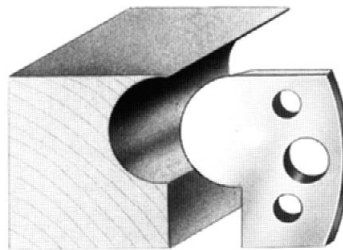
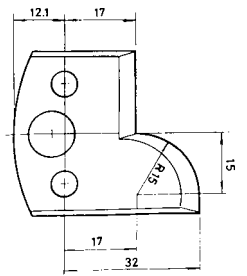

58

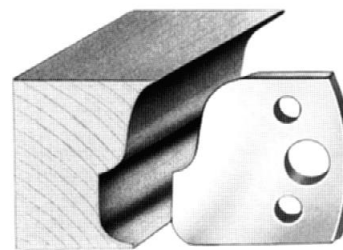
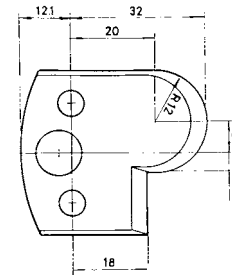

59

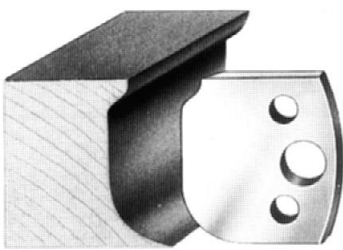
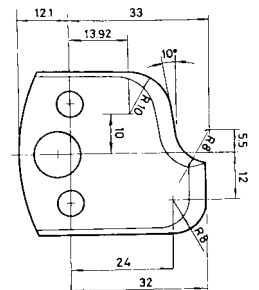

60

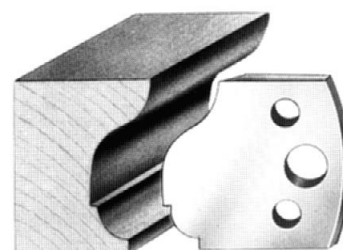
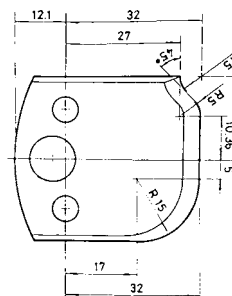

61

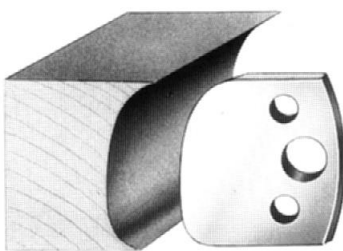
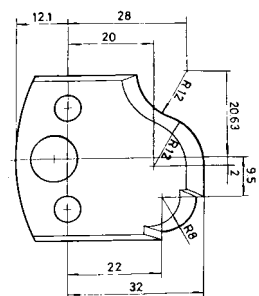

62

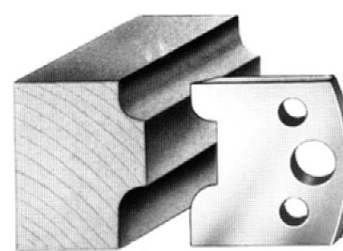
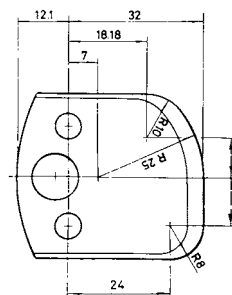

63

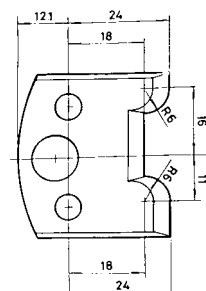

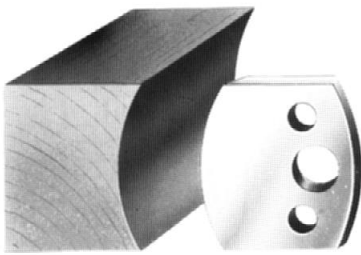

87

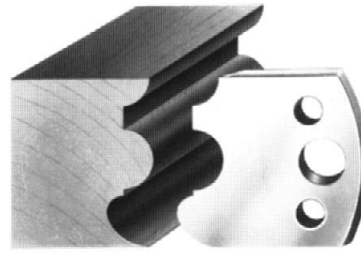
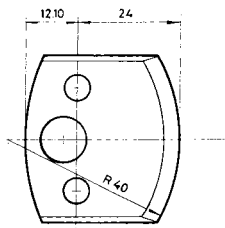

88

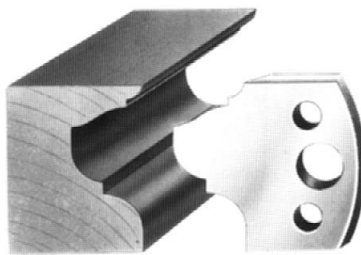
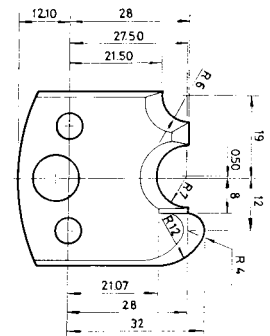

89

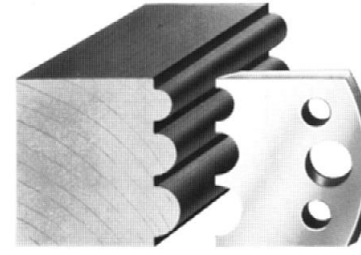
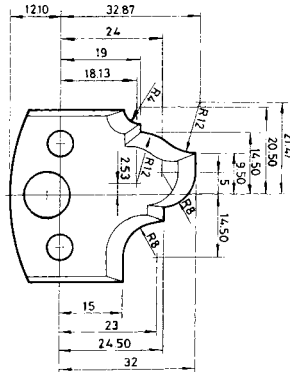

90

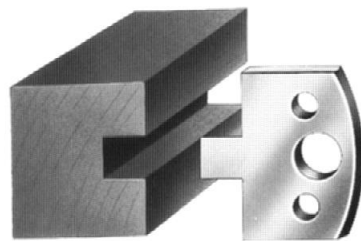
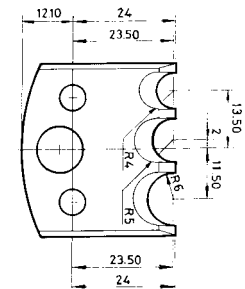

91

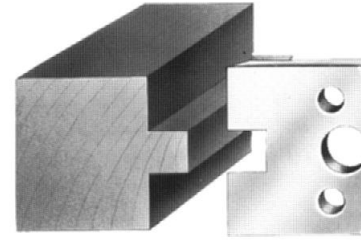
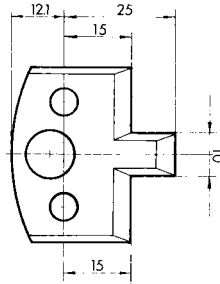

92

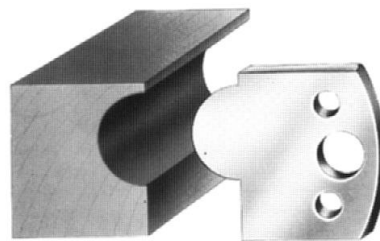
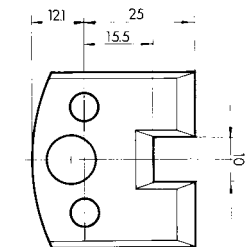

93

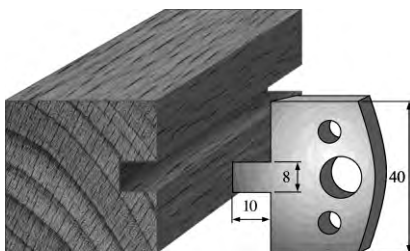
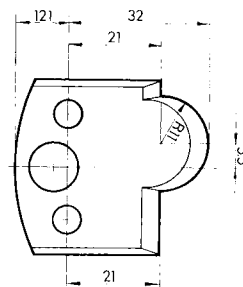

94

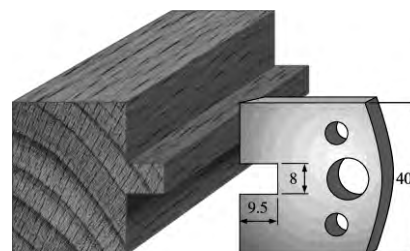

95

